

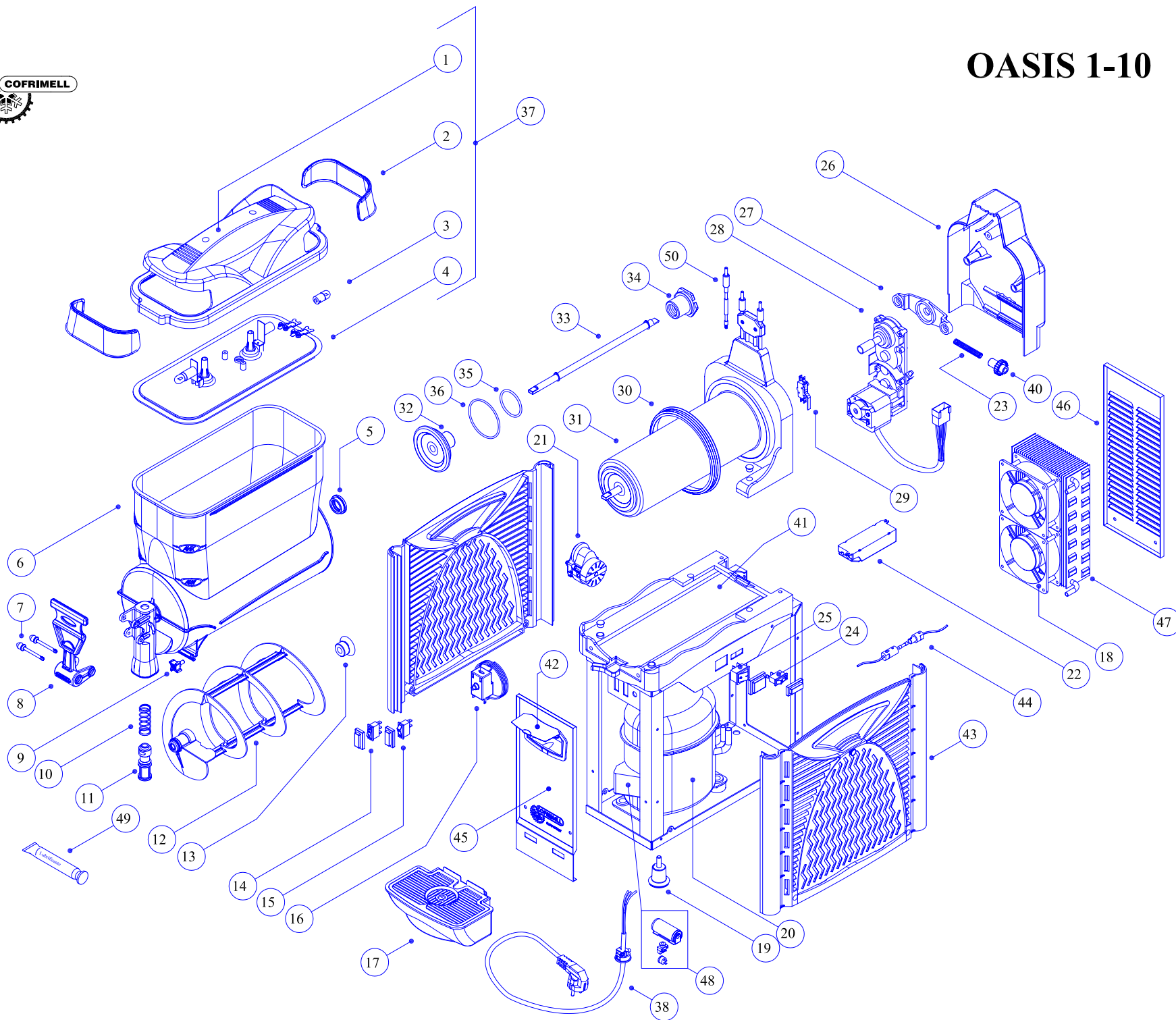

OASIS 1-10



OASIS 1-10

| Pos. | Codice | Ricambi | Spare parts | Rechange | Repuestos |
|------|--------|--------------------------------------|------------------------------|-------------------------------------|-----------------------------------|
| 1 | 2107 | Coperchio | Lid | Couvercle | Tapa |
| 2 | 2122 | Schermo coperchio Oasis | Screen for lid | Schèmes couvercle | Pantalla tapa |
| 3 | 2158 | Lampadina 12V - 10W | 12V-10W lamp | Ampoule 12V-10W | Bombilla 12V-10W |
| 4 | 2127 | Sottocoperchio | Under-lid | Sous - couvercle | Tapa inferior |
| 5 | 2112 | Ghiera per girante | Metal ring for spiral blade | Frette pour vis s.f. | Abrazadera espiral |
| 6 | 2133 | Vasca Oasis 10 lt | Bowl Oasis 10Lt | Cuve 10 Lt | Tanque Oasis 10 Lt |
| 7 | 2150 | Perno rotazione leva | Rotation pin | Pivot rotation levier | Pivote rotación palanca |
| 8 | 2117 | Leva rubinetto | Tap lever | Levier robinet | Palanca grifo |
| 9 | 2149 | Pomello | Fixing knob | Pommeau | Pomo de fijado |
| 10 | 2120 | Molla rubinetto | Tap spring | Ressort robinet | Muella grifo |
| 11 | 2134 | Valvola rubinetto | Tap valve | Soupape robinet | Válvula grifo |
| 12 | 2113 | Girante | Spiral blade | Vis san fin | Espiral |
| 13 | 2115 | Guarnizione Girante-Mozzo | Spiral blade gasket | Joint vis s.f.-moyeu | Guarnición espiral |
| 14 | 2137 | Deviatore Granita-Bibita | Slush/Drink switch | Deviateur Granité-Boisson | Interruptor Granizador-Bebida |
| 15 | 56 | Interruttore Girante | Spiral blade switch | Interrupteur vis s.f. | Interruptor espiral |
| 16 | 2160 | Termostato | Thermostat | Thermostat | Termòstato |
| 17 | 2161 | Vaschetta raccogliacqua completa | Complete drip tray | Cuvette d'écoulement complete | Cajon gotero |
| 18 | 182 | Mot.Vent. Comp. 220-240 V - 50/60 Hz | Fan motor 220-240V - 50/60Hz | Moteur ventilateur 220-240V-50/60Hz | Motor ventilador 220-240V-50/60Hz |
| | 68 | Mot.Vent. Comp. 115 V - 60 Hz | Fan motor 115V - 60Hz | Moteur ventilateur 115V- 60Hz | Motor ventilador 115V- 60Hz |
| 19 | 2153 | Piedino livellatore H=35 | Rubber leg H=35 | Pieds de réglage h,= 35 | Patita nivelador |
| 20 | 2164 | Compressore 220-240V - 50Hz | Compressor 220-240V-50Hz | Compresseur 220-240V-50Hz | Compressor 220-240V-50Hz |
| | 2165 | Compressore 115V - 60Hz | Compressor 115V-60Hz | Compresseur 115V-60Hz | Compressor 115V-60Hz |
| 21 | 2162 | Timer 220V - Temporizzatore 4' | Timer 220V (4 min) | Timer 220V-Temporisateur 4' | Temporizador 220V |
| | 2163 | Timer 115V - Temporizzatore 4' | Timer 115V (4min) | Timer 115V-Temporisateur 4' | Temporizador 115V |
| 22 | 2166 | Trasformatore 220-240V - 50Hz | Transformer 220-240V - 50Hz | Transformateur 220-240V - 50Hz | Transformador 220-240V - 50Hz |
| | 2167 | Trasformatore 115V - 60Hz | Transformer 115V - 60Hz | Transformateur 115V - 60Hz | Transformador 115V - 60Hz |
| 23 | 2157 | Molla regolazione densità | Thickness control spring | Ressort régulation densité | Muella regulación densidad |
| 24 | 56 | Interruttore luce | Light switch | Interrupteur lumier | Interruptor luz |
| 25 | 57 | Interruttore generale | Main switch | Interrupteur général | Interruptor general |

| Pos. | Codice | Ricambi | Spare parts | Rechange | Repuestos |
|------|---------|--------------------------------------|-----------------------------------|--------------------------------|-------------------------------------|
| 26 | 2108 | Coperchio supp. posteriore | Back support cover | Couvercle support posterieurs | Tapa soporte posterior |
| 27 | 2131 | Staffa per motoriduttore | Motor-gearbox support | Étrier pour motoreducteur | Estribo |
| 28 | 2121 | Motoriduttore 220/115V - 50/60Hz | Motor-gearbox 220/115V-50/60hz | Motoreducteur 220/115V 50-60Hz | Motor reductor 220/115V 50-60Hz |
| 29 | 2168 | Micro interruttore | Micro-switch | Microinterrupteur | Micro-interruptor |
| 30 | 2116 | Guarnizione vasca | Bowl gasket | Joint cuve | Guarnición tanque |
| 31 | 2110 | Evaporatore | Evaporator | Evaporateur | Evaporador |
| 32 | 2145 | Mozzo completo | Evaporator cover | Moyen complete | Cubo evaporador |
| 33 | 2101 | Albero trasmissione | Transmission shaft | Arbre trasmission | Árbol de transmisión |
| 34 | 2111 | Ghiera M25 | Metal ring M25 | Frette M25 | Abrazadera M25 |
| 35 | 2123 | OR interno mozzo piccolo | Evaporator cover inner OR (small) | OR intérieur moyen petit | OR interior cubo pequeño |
| 36 | 154 | OR interno mozzo grande | Evaporator cover inner OR (large) | OR intérieur moyen grand | OR interior cubo grande |
| 37 | 2159 | Coperchio completo | Complete lid | Couvercle complete | Tapa completa |
| 38 | 2170 | Cavo alimentazione 220V | Cable cord 220V | Câble d'alimentation 220V | Cable alimentación 220V |
| | 2171 | Cavo alimentazione 115V | Cable cord 115V | Câble d'alimentation 115V | Cable alimentación 115V |
| 40 | 2169 | Manopola regolazione granita | Thickness control knob | Bouton régulation granité | Manopla regulación densidad |
| 41 | 2125 | Piano evaporatore | Evaporator plate | Plan évaporateur | Banco evaporador |
| 42 | 2126 | Scatola comandi | Switches box | Boîte commande | Caja interruptores |
| 43 | 2148 | Pannello laterale | Side panel | Panneau latérales | Panel lateral |
| 44 | 2172 | Fusibile | Fuse | Fusible | Fusible |
| 45 | 2220 | Pannello frontale | Front panel | Panneau frontal | Panel frontal |
| 46 | 2174 | Pannello posteriore | Back panel | Panneau posterieur | Panel posterior |
| 47 | 2175 | Scambiatore di calore | Condenser | Condensateur | Condensador |
| 48 | 2164.01 | Kit parti elettriche 220-240V - 50Hz | Electric parts kit 220-240V-50Hz | Kit électrique 220-240V-50HZ | Kit partos elèctricos 220-240V-50Hz |
| | 2165.01 | Kit parti elettriche 115V - 60Hz | Electric parts kit 115V-60Hz | Kit électrique 115V- 60Hz | Kit partos elèctricos 115V-60Hz |
| 49 | 2118 | Tubetto lubrificante | Lubricant tube | Tube lubrifiante | Tubo lubricante |
| 50 | 2103 | Asta contatti elettrici | Electric contact shaft | Tige contact électrique | Asta contactas electricos |
| 51 | 2105 | Bobina 220V-50/60Hz | Coil 220V -50/60Hz | Bobine 220V -50/60Hz | Bobina 220V-50/60Hz |
| 51 | 2183 | Bobina 115V -50/60Hz | Coil 115V -50/60Hz | Bobine 115V- 50/60Hz | Bobina 115V-50/60Hz |