

---

**convection steamer | electric convection steamer | CXE 120**

---

<b>Pos</b>	<b>Partnumber</b>	<b>Quantity</b>	<b>Description</b>
1A	100 341	1	scale ring f. bain-marie Garraumtemperatur
1A	100 309	1	scale ring f. bain-marie Room temperature
1B	100 342	1	scale ring f. bain-marie Garraumtemperatur
1B	100 307	1	scale ring f. bain-marie Room temperature
2A	189 009	3	knob with flat spring black
2B	100 136	3	knob holder ab Mitte 2012
3A	100 306	1	scale ring f. bain-marie Cycle duration
3B	100 340	1	scale ring f. bain-marie Prozessdauer
5A	100 305	1	scale ring f. bain-marie Core temperature
5B	100 339	1	scale ring f. bain-marie Kerntemperatur
7	745 814 002	1	
9	133 033	1	
10	172 855	1	Spray gun
11	134 643	4	foot of the unit 150-230mm
12	163 626	1	
13	120 121	2	fan motor
15	164 010	1	solenoid 3 Fach 3/4"
16	164 016	1	solenoid 2 Fach 90° 3/4"
17	164 017	1	solenoid 3 Fach 90° 3/4"
18	120 403	1	
19	174 262	1	fan wheel
20	061 021	1	hose Polyamid
21	178 410	1	fan wheel 230-240V

22	060 823	5	10-10
23	060 824	2	10-10
24	060 825	7	10-10
25	060 826	1	
26A	165 281	1	
26B	164 934	1	
27	164 955	1	
28	165 280	1	
29	152 432	1	temperature limiter
30	164 706	1	transformer 60W for oven lighting
31	185 776	1	contactor 230V 50HZ
32	185 830	4	contactor 230V 50HZ
34	185 583	4	junction terminal 16 mm <sup>2</sup>
35	161 633	1	detecting device PT1000
36	184 683	1	safety clamp
37	186 276	1	stop plate
38	216 325	1	fuse M 4A 5x20
39	185 585	1	protective conductor clamp 16 mm <sup>2</sup>
40	161 642	1	core temperature sensor schwarz PT1000
41	161 641	1	core temperature sensor weiss PT1000
42	986 164 002	1	cover
43	181 741	9	heating element recirculating air 230V
44	738 971 000	1	support panel für Beleuchtung
45	060 323	2	gasket for lighting
46	103 702	2	glass cover for lighting
47	163 000	2	halogen lamp 12V, 20W

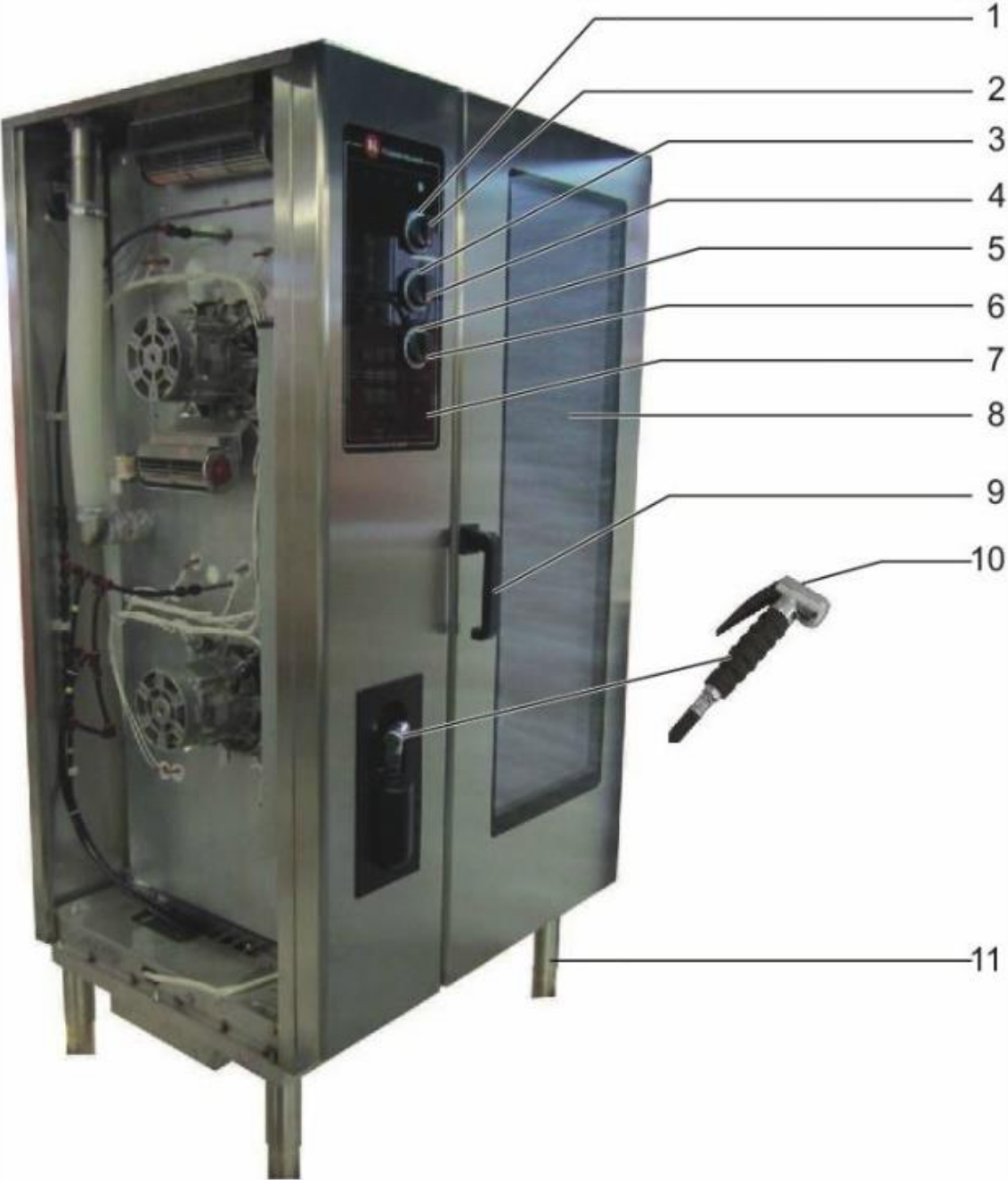

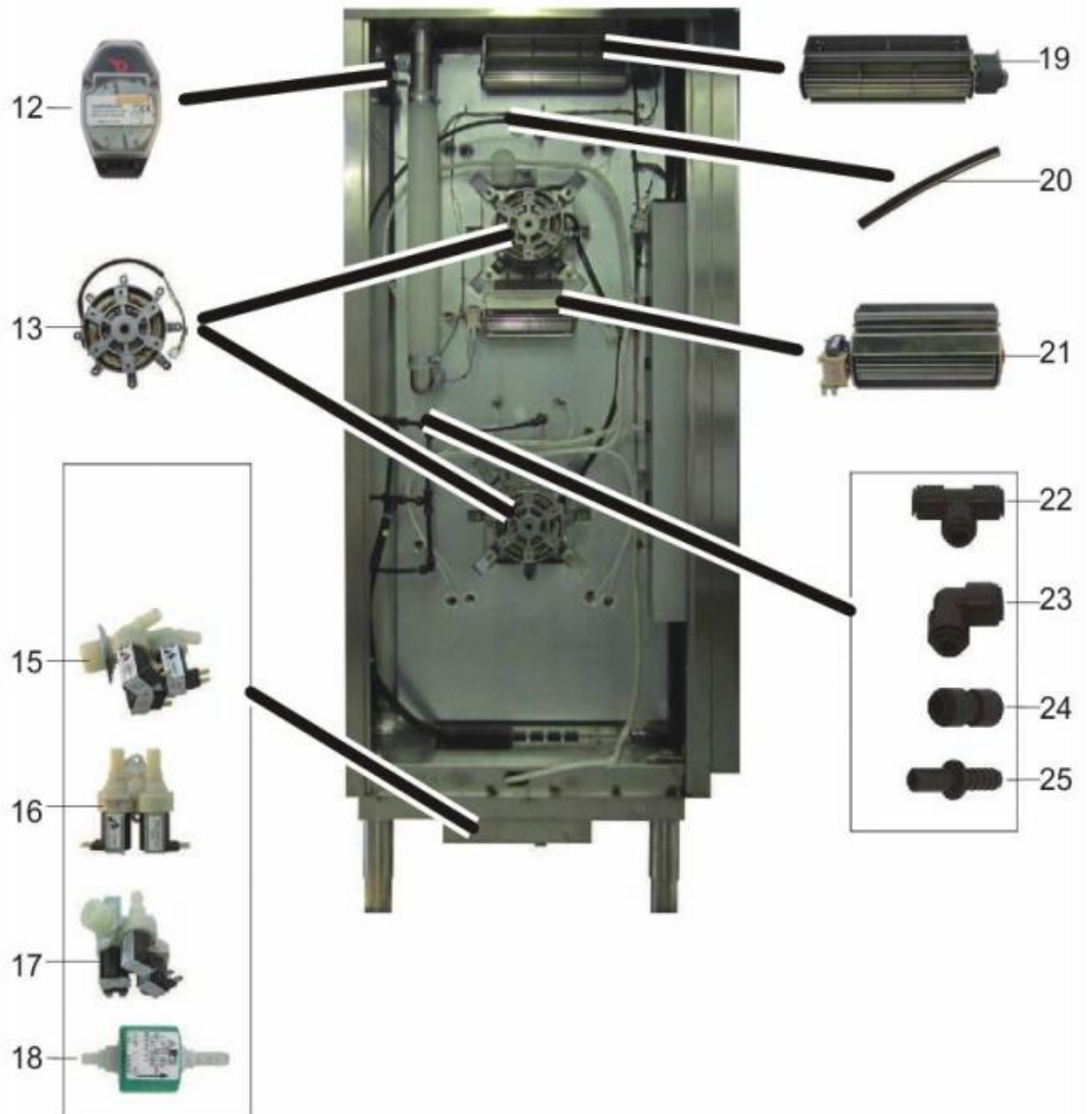

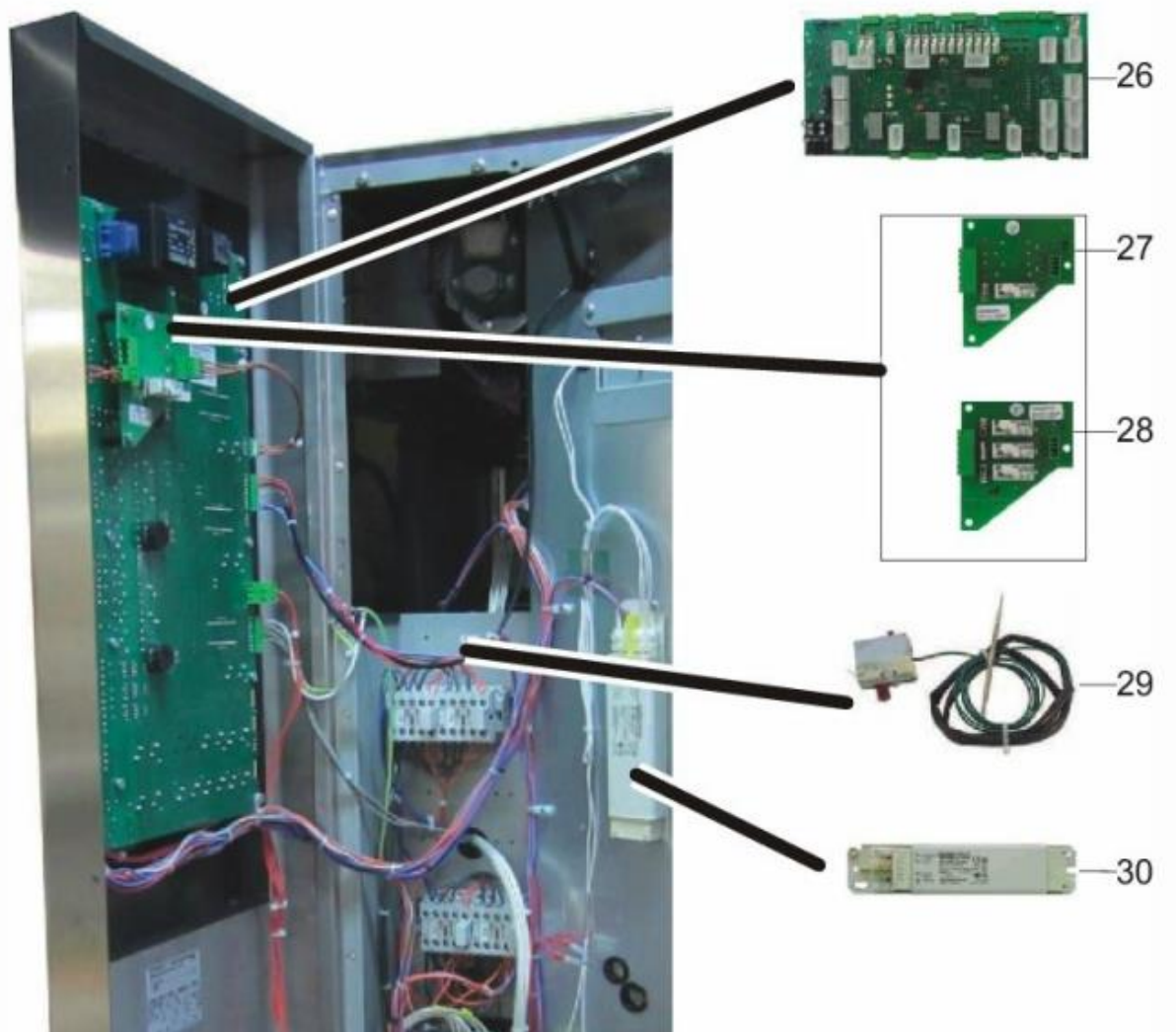

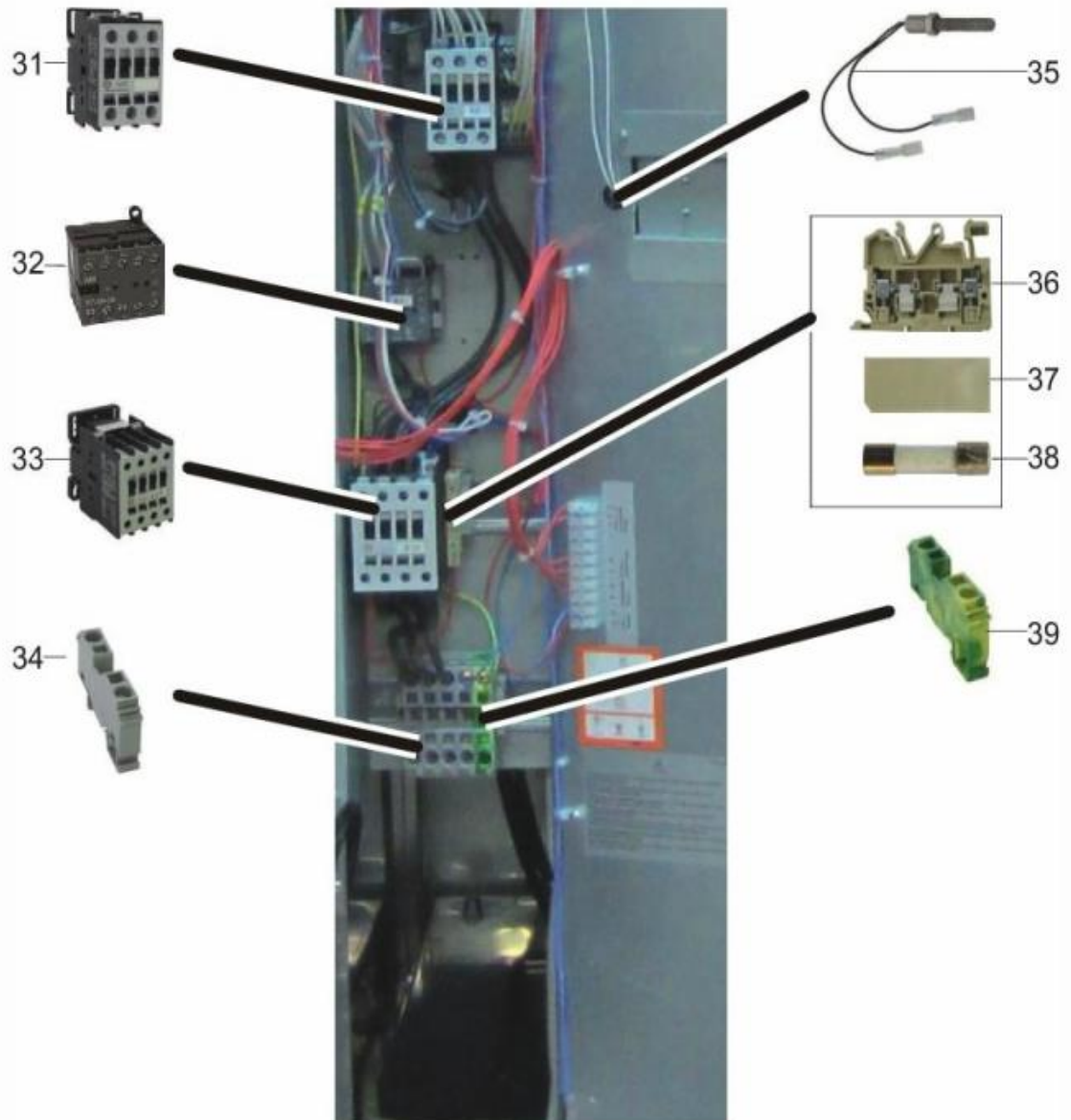



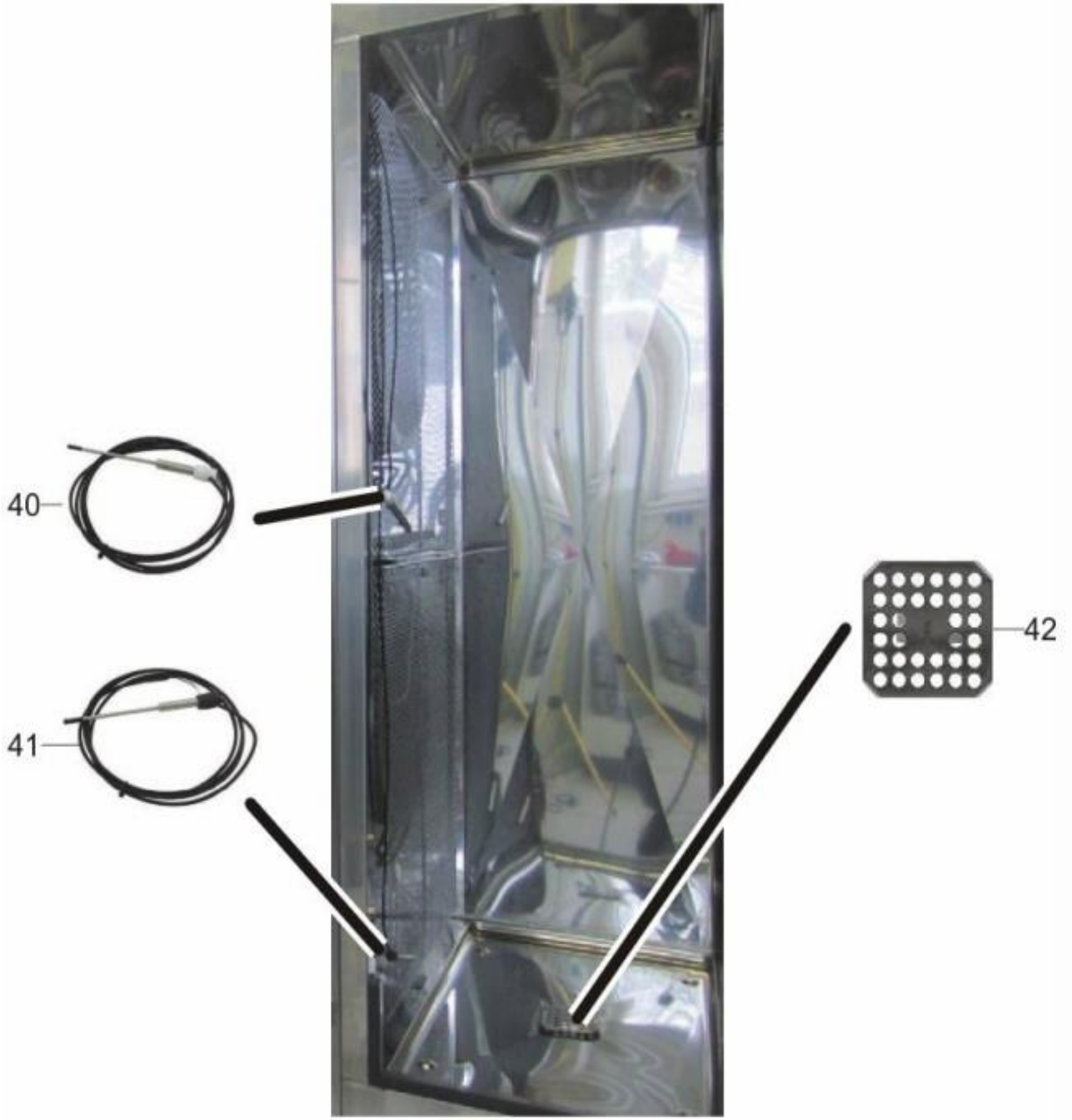

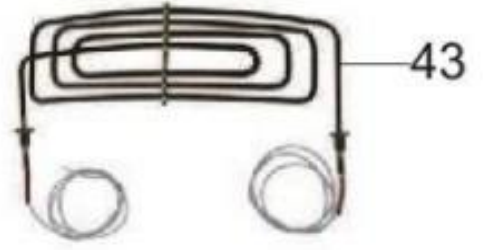



44

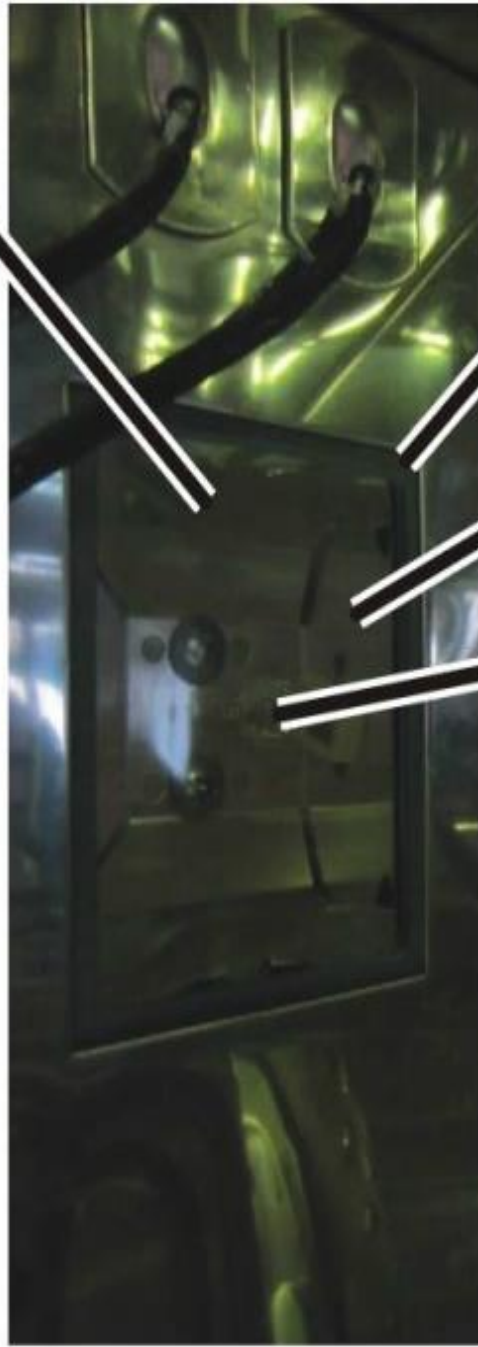

45



46



47

